

CNC Tool Grinder NTG-43

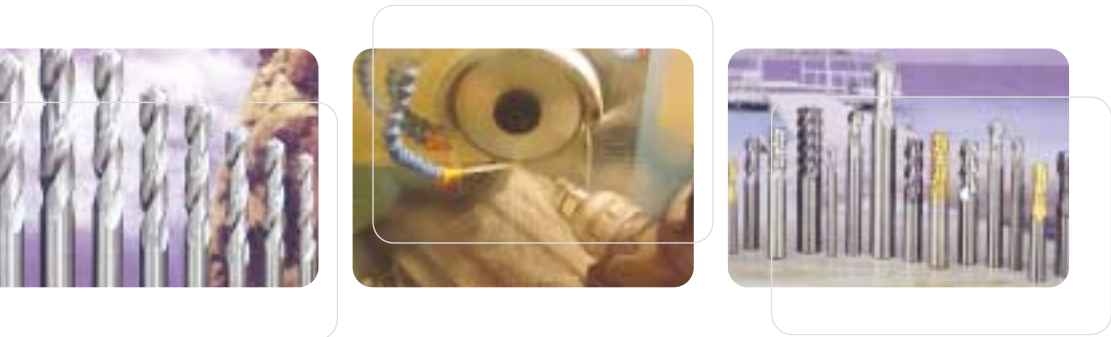

Specifications are subject to change without notice.

NS SYSTEM CO., LTD.

Sinyong B/D 4F #942-6 Ingye-dong, Paldal-gu,
Suwon-city, Kyungki-do, Korea
TEL. 82-31-235-7492~6
FAX. 82-31-235-7497
<http://www.nssystem.co.kr>



The high productivity manufacturing of ultra precision tools



High precision technology, combination of wide range of experience and a tradition of craftsmanship

PRECISION

- Digital servo systems for high precision, high reliability.
- Direct drive built-in spindle, which eliminates vibrations and mechanical assembly.
- Precision collet chuck for fine tolerance tools.
- Maximum torque, minimum backlash gear heads for high performance.
- Precision ball screws and LM guides.

FEATURES

- Ultra high grinding speed.
- Very compact design, small footprint machine.
- User-friendly interface for quick setup.
- Cost-effective short run production jobs.
- Full enclosed splash guard.
- Large working envelope for grinding tools from 0.7mm to 25.4 mm diameter up to 150mm long.



The ideal balance of cost, size and capabilities



User friendly 4 axis CNC for tool grinder

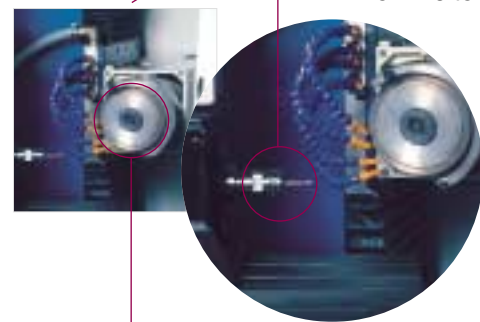

Precision collet chuck for fine tolerance

High power grinding wheel spindle motor

- Direct drive built-in spindle
- Low vibrations
- 10Hp(7.5kW)
- 6000rpm(variable)



Optional oil mist duct

Light in the splash guard

Full enclosed splash guard

Operator's panel



Sludge free centrifugal separator unit

Automatic lubrication system

The user-friendly interface by Graphic touch terminal



MPG feed for fast and easy programming

Easy-to-use programming of tool data for quick job setup

USB unit for easy tool data management

Diagnostic port

Machine Dimensions

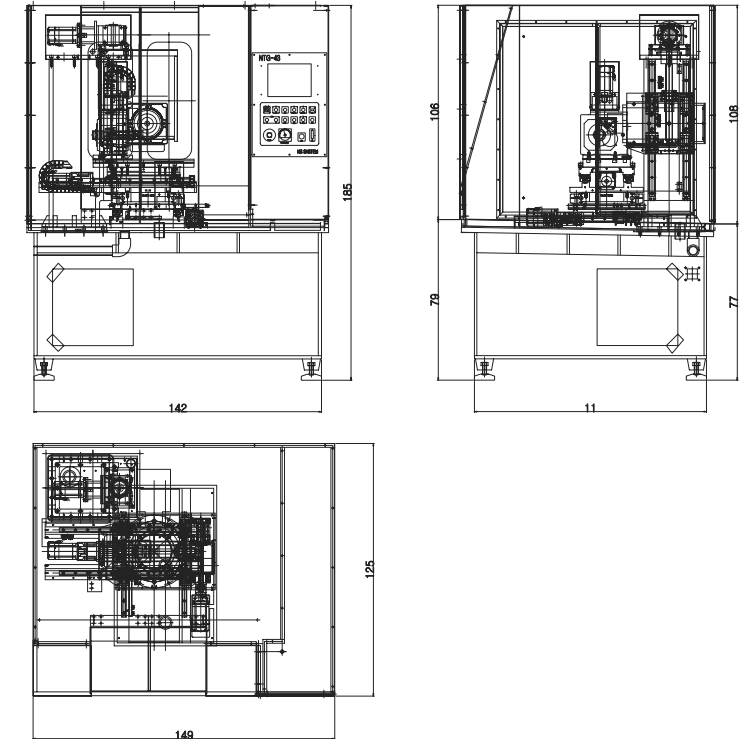

Tool Data Module

Items	Descriptions	Unit
XINT	X-axis grinding start position	0.001 mm
YINT	Y-axis grinding start position	0.001 mm
ZINT	Z-axis grinding start position	0.001 mm
XISPD	Grinding start position approach speed (X, Y-axis)	mm/min
ZISPD	Grinding start position approach speed (Z-axis)	mm/min
DEPTH	Flute depth	0.001 mm
DNSPD	Z-axis down speed	mm/min
LENGTH	Flute length	0.001 mm
ANGLE	Helix angle	0.001 °
FLUTE	No. of flute	
DIAMT	Diameter of tool	0.001 mm
DIREC	Helix direction(0 : right-handed, 1 : left-handed)	
TLWEB	Increment of WEB	0.001 mm
SPEED	Grinding feed speed	mm/min
DWELL	Dwell time	0.01 sec
ZRLen	Z-axis up return height	0.001 mm
ZRSPD	Z-axis return speed	mm/min
XRSPD	X, A-axis return speed	mm/min
ATSPD	A-axis rotation speed	°/min
TAPER	taper angle	0.001 °

Machine Specifications

Items	Specification	Range	Remark
Grinding Capacity	Shank diameter	φ0.7 ~ φ25.5mm	
	Overall tool length(max)	300mm	
	Flute length(max)	150mm	
	Tool diameter(max)	φ200mm	
	Helix angle	-10~90°	
Movement Range	X-axis(Longitudinal movement of work head)	200mm	CNC
	Y-axis(Cross movement of table)	100mm	CNC
	Z-axis(Vertical movement of wheel head)	200mm	CNC
	A-axis(Rotary movement of work spindle)	9999°	CNC
	U-axis(Rotary movement of swivel arm)	-10~90°	Manual/CNC
Axis feedrate	X, Y-axis(max)	1950mm/min	
	Z-axis(max)	1950mm/min	
	A-axis(max)	4000°/min	
	U-axis	Manual/4000°/min	
Work Spindle Taper	Taper	MT4	
Grinding Wheel Spindle	Grinding speed motor (Built-in direct spindle)	10Hp, 2000~6000rpm	Inverter
	Grinding wheel size (CBN or diamond)	φ200(max) × 31.75mm	
Electric Power		AC220V, 3 φ, 10KVA	
Dimensions		1495(W) × 1300(L) × 1860(H)	
Weight		1800kg	

Standard & Optional

Items	Standard	Optional
Spindle Motor	10Hp(7.5kw)	Other capacity order made
Wheel Sleeve	5set	
Collet Wrench	1ea	
Sleeve Wrench	1ea	
Wheel Cover	1ea	
MT Collet Chuck (MT4-SK16-160S)	1ea	
Work Lamp	1ea	
Collar Nut(M12)	4ea	
T-Bolt(M12)	4ea	
Lubrication System	Automatic	Manual
Program	Helical	Taper
Hand tool set		Optional

Items	Optional	Remark
Tail stock	Order made	
Tool supporter	Order made	
Oil mist collector	Order made	
Coolant tank	Order made	80~160 ℓ
Centrifugal separator	Order made	80~160 ℓ
Auto chucking	Order made	
Auto loading	Order made	Robot